



### KEY FEATURES

- Available with 30° (narrow) or 100° (wide) symmetric optics
- Hazardous location available
- Thermally managed for maximum longevity
- Adjustable mounting bracket
- Operation and environmental benefits of LED technology
- Robust construction suitable for outdoor applications



### MODEL NUMBER SELECTOR Example: CANLED-CW-W-ALU-GEN

MODEL	COLOUR	OPTIC	FINISH	LOCATION
CANLED				GEN
	<b>CW</b> - Cool White <b>NW</b> - Neutral White <b>WW</b> - Warm White <b>CUS</b> - Custom <i>Contact for custom colour</i>	<b>N</b> -Narrow <b>W</b> -Wide <b>NF</b> -Narrow Frosted <b>WF</b> -Wide Frosted	<b>ALU</b> -Aluminium <b>CUS</b> -Custom <i>See pg2 for custom finishes</i>	<b>GEN</b> - General <i>C1D2 Available for Hazardous Locations</i> <i>See CANLED-C1D2</i>

### TECHNICAL SPECIFICATIONS / MAXIMUM RATINGS

HOUSING	Aluminum
MOUNTING	Aluminum Yoke
VOLTAGE MAXIMUM	28 VDC
TYPICAL INPUT VOLTAGE	12-24 VDC
POWER	7.9 W @ 12 VDC   8.4 W @ 24 VDC
CURRENT	0.66 A @12 VDC   0.35 A @ 24 VDC
CONNECTIONS	6Ft Flying Lead (Custom Lengths Available)
TEMPERATURE RANGE	-40° C to +85° C
TYPICAL CASE TEMPERATURE	~15° C Above Ambient Temperature
CERTIFICATIONS	Certified To CSA 22.2 No. 250.0, Conforms To UL 1598
INGRESS PROTECTION	IP66
COLOUR TEMP RANGE	CW: 6500K   NW: 4300K   WW: 3500K
CRI VALUE	CW: 75   NW: 75   WW: 80
TOTAL LUMENS	CW-W: 459   C W-N: 587
LUMEN MAINTENANCE	LM-80 > 60,500 hrs (Based on CREE long term testing)
WEIGHT	2.3 lb   1.04 kg

\* The ambient temperature during lifetime, lumen and chromaticity determination is 25° C ± 1° C

### DIMENSIONS

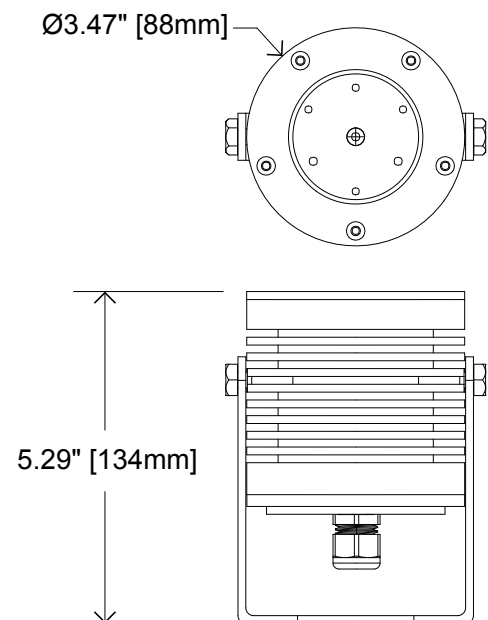

**PHOTOMETRICS**

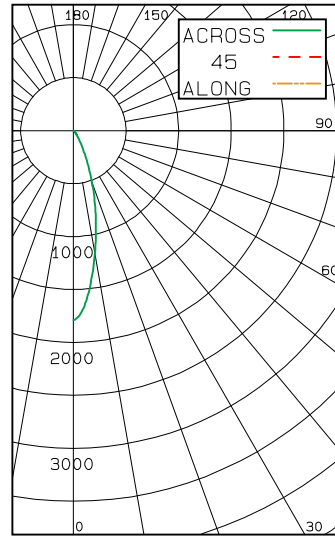
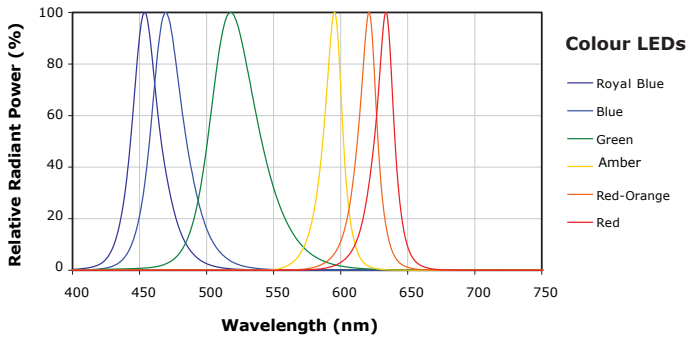
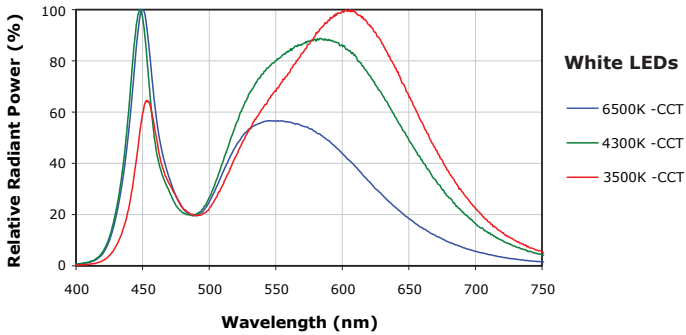

**NARROW BEAM**  
(Clear Lens)

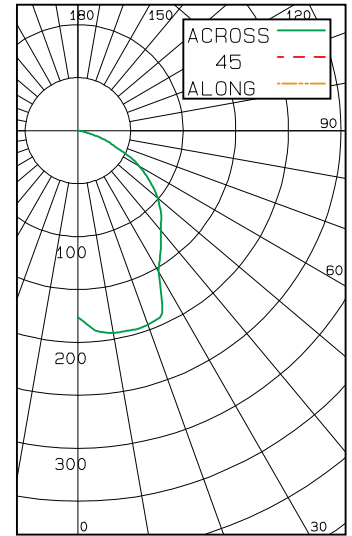

**WIDE BEAM**  
(Clear Lens)



**MOUNTING OPTIONS**

**MOUNTING BRACKET**

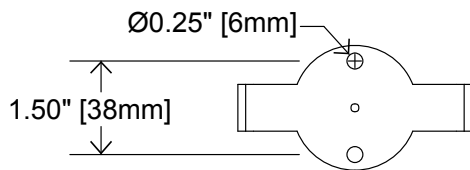

**OPTIC OPTIONS**

**NARROW BEAM**



**WIDE BEAM**



**FROSTED LENS**



**CUSTOM OPTIONS**

**WIRING**

Other wire lengths available in 1 foot increments.

**CUSTOM FINISHES**

**Anodized Aluminum**

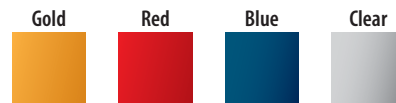

Please contact for further options

**Powder Coated Aluminum**



Please contact for further options